

Installation Instructions

Please Read Before Installing

Visor Control Receiver

HR-VCRX-SW

120 V~, 50/60 Hz (9 V==, 300 mA Adapter, included)

Overview

The HR-VCRX-SW Visor Control Receiver is for use with *HomeWorks* systems in conjunction with the Visor Control Transmitter (HR-VCTX-SW), and allows the activation of home lighting scenes, garage doors, or gates remotely (using the Visor Control Transmitter) from a vehicle.

Up to ten (10) Visor Control Transmitters may be used with each Visor Control Receiver.

Each Visor Control Receiver occupies one RF Keypad address on the *HomeWorks* RF Processor. Up to 32 RF Keypads, each with a unique address, may be assigned to an RF Processor.

Important Notes

Codes: Install in accordance with all local and national electrical codes.

Power: Use only the adapter provided by Lutron with the Visor Control Receiver.



Caution - Using an adapter not rated for the following specifications could damage the Receiver and possibly overheat the adapter.

- Input: 120 V~, 50/60 Hz
- Output: 9 V==, 300 mA Class 2

Environment: Ambient operating temperature: 0-40°C, 32-104°F, 0-90% humidity, non-condensing. Indoor use only.

Finish: Do not paint the control.

Cleaning: To clean, wipe with a clean damp cloth. **DO NOT** use any chemical cleaning solutions.

RF Device Placement: Visor Control Receivers must be located within 30 feet (9 m) of an RF Signal Repeater or an RF Processor.

Setup: Programmable buttons on the Receiver will not function until the Receiver is addressed and programmed using the *HomeWorks* Utility. Buttons are for programming and testing only.

Transmitter to Receiver Range: Approximately 150 feet (46 m). The performance of the Visor Control Transmitter with the Visor Control Receiver is highly dependent upon a variety of complex factors such as:

- Distance
- Construction of walls
- Electrical equipment nearby

HR-VCRX-SW

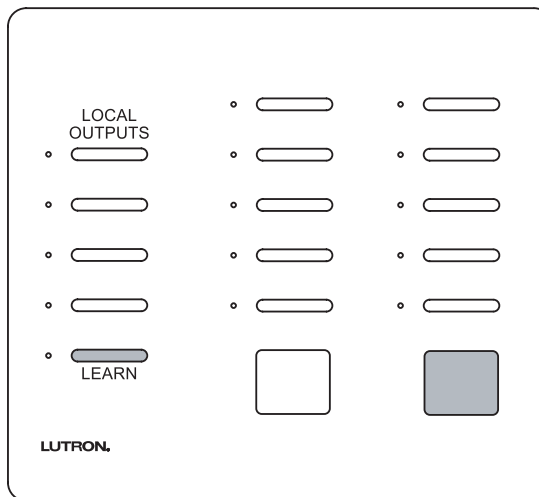

Installation

Note: Lutron recommends mounting the Receiver in a discreet location where the control may be accessed for programming purposes.

1. Connect contact closure output wiring (if applicable). Connect the wiring to the contact closure output terminal blocks using Class 2 cable. See Relay Contact Ratings (page 3).



Caution - Do not connect high voltage wiring to the contact closure output terminal blocks. See Relay Contact Ratings (page 3).

2. Plug power cord into Receiver.
3. Plug adapter into wall outlet.

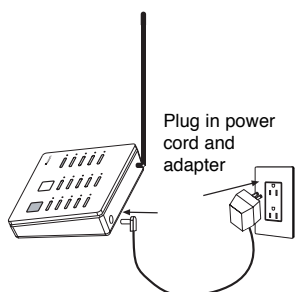

Wall Mounting

Visor Control Receivers may be wall mounted using the supplied wall bracket.

1. Attach wall bracket to wall using the supplied screws and wall anchors.

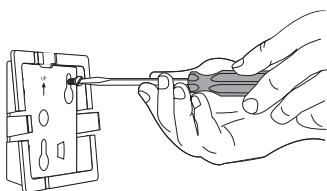

2. Place adapter cord into notches at top and bottom of wall bracket. Place contact closure wiring (if applicable) into cutout at top of wall bracket. Align Receiver and snap onto wall bracket.

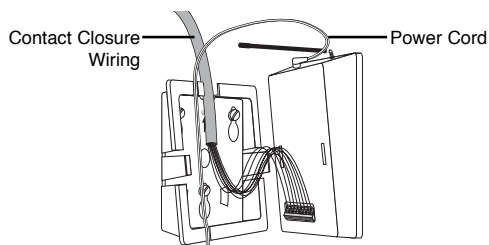

Setup

It is recommended that the Visor Control Receiver be programmed into the HomeWorks® system before proceeding.

1. Plan which buttons on the Visor Control Receiver are to learn Visor Control Transmitter buttons.

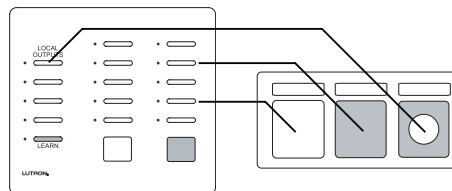

2. Enter LEARN Mode. Press and hold the LEARN button on the Visor Control Receiver until the green LEARN LED turns ON (approximately 3 seconds).
3. Select Receiver button. Press and release Receiver button that is to learn a Transmitter button; its LED will turn ON.

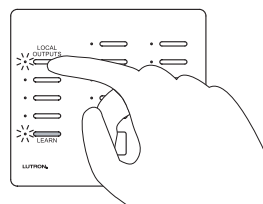

LED turns ON.

- If the large white button is selected, all LEDs in the center column will turn ON.
- If the large gray button is selected, all LEDs in the right most column will turn ON.

4. Select Transmitter button that is to be learned by the Receiver. Press and hold the Visor Control Transmitter button until the orange LED next to the selected Receiver button flashes (approximately 3 seconds). The LEARN LED will flash whenever the Receiver “hears” the Transmitter.

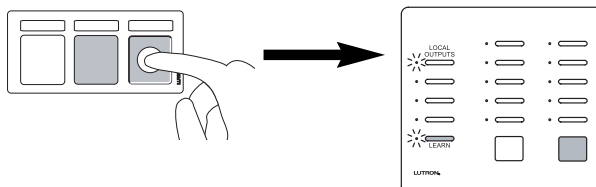

The orange LED will turn OFF after the Visor Control button is released. The green LEARN LED will stay ON.

5. Verify that the Receiver button has learned the Transmitter button by pressing the Transmitter button again. The orange LED corresponding to the learned button on the Receiver will flash. The LEARN LED will also flash.
6. Repeat steps 3 and 4 to learn additional Transmitter buttons.
7. Exit LEARN Mode. Press and release the LEARN button.

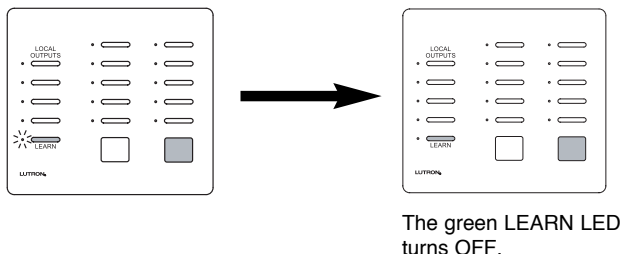

Operation

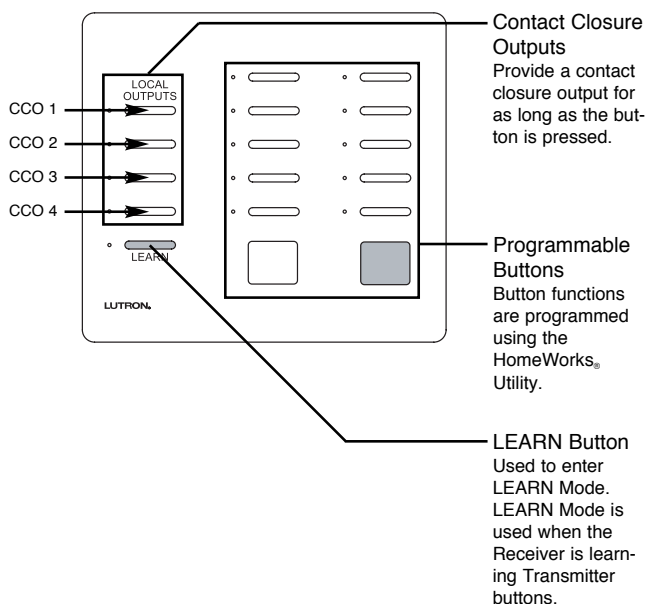

Wiring Diagram

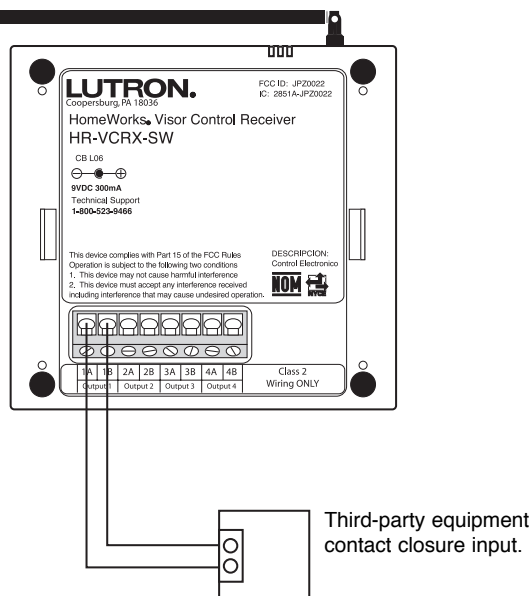

Relay Contact Ratings

Voltage	Resistive Load	Inductive Load
Up to 30 VDC	1 A	0.2 A
Up to 30 VAC	1 A	0.1 A
Up to 60 VDC	0.5 A	Do not use
Up to 42.4 VAC	0.5 A	Do not use

Troubleshooting Guide

Symptom	Cause and Action
LEDs on the Receiver do not light.	No power available to Receiver. <ul style="list-style-type: none">• Verify adapter is plugged in and receptacle is powered. Faulty adapter. <ul style="list-style-type: none">• Replace adapter.
Pressing a programmable button on the Receiver (or its learned Visor Control Transmitter button) causes the Receiver to <i>quickly</i> flash all its LEDs simultaneously.	Receiver has not been addressed. <ul style="list-style-type: none">• See the HomeWorks® Utility online help for setup details.
Pressing a programmable button on the Receiver (or its learned Visor Control Transmitter button) causes the Receiver to <i>slowly</i> flash all its LEDs simultaneously.	Receiver has an address, but has not been programmed. <ul style="list-style-type: none">• Upload programming to system using the <i>HomeWorks</i> Utility.
The Visor Control Transmitter is not communicating with the Visor Control Receiver.	Visor Control Transmitter has not been learned to Visor Control Receiver. <ul style="list-style-type: none">• Learn Transmitter to Receiver, following the instructions on page 2.

FCC Information

Note: This equipment has been tested and found to comply with the limits for a Class B digital device, pursuant to Part 15 of the FCC rules. These limits are designed to provide reasonable protection against harmful interference in a residential installation. This equipment generates, uses and can radiate radio frequency energy and, if not installed in accordance with the instructions, may cause harmful interference to radio communications. However, there is no guarantee that interference will not occur in a particular installation. If this equipment does cause harmful interference to radio or television reception, which can be determined by turning the equipment off and on, the user is encouraged to try to correct the interference by one or more of the following measures:

- Reorient or relocate the receiving antenna.
- Increase the separation between the equipment and receiver.
- Connect the equipment into an outlet on a circuit different from that to which the receiver is connected.
- Consult the dealer or an experienced radio/TV technician for help.

Caution: Changes or modifications not expressly approved by Lutron Electronics Co. could void the user's authority to operate this equipment.

Technical and Sales Assistance

If you need assistance, call the toll-free **Lutron Technical Support Center**. Please provide exact model number when calling.

(800) 523-9466 (U.S.A., Canada and the Caribbean)

Other countries call:

Tel: (610) 282-3800

Fax: (610) 282-3090

Visit our Web site at www.lutron.com

LIMITED WARRANTY

Lutron will, at its option, repair or replace any unit that is defective in materials or manufacture within two years after purchase. For warranty service, return unit to place of purchase or mail to Lutron at 7200 Suter Rd., Coopersburg, PA 18036-1299, postage pre-paid. Telephone the Lutron Technical Support Center toll free at 800-523-9466. After the two year period, a pro-rated warranty applies to this product until eight years after the purchase. For more information regarding this warranty contact your Lutron representative.

THIS WARRANTY IS IN LIEU OF ALL OTHER EXPRESS WARRANTIES, AND THE IMPLIED WARRANTY OF MERCHANTABILITY IS LIMITED TO TWO YEARS FROM PURCHASE. THIS WARRANTY DOES NOT COVER THE COST OF INSTALLATION, REMOVAL OR REINSTALLATION, OR DAMAGE RESULTING FROM MISUSE, ABUSE, OR IMPROPER OR INCORRECT REPAIR, OR DAMAGE FROM IMPROPER WIRING OR INSTALLATION. THIS WARRANTY DOES NOT COVER INCIDENTAL OR CONSEQUENTIAL DAMAGES. LUTRON'S LIABILITY ON ANY CLAIM FOR DAMAGES ARISING OUT OF OR IN CONNECTION WITH THE MANUFACTURE, SALE, INSTALLATION, DELIVERY, OR USE OF THE UNIT SHALL NEVER EXCEED THE PURCHASE PRICE OF THE UNIT.

This warranty gives you specific legal rights, and you may also have other rights which vary from state to state. Some states do not allow limitations on how long an implied warranty lasts, so the above limitation may not apply to you. Some states do not allow the exclusion or limitation of incidental or consequential damages, so the above limitation or exclusion may not apply to you. This product may be covered by one or more of the following U.S. patents: 5,736,965; 5,838,226; 5,905,442; 5,982,103; D389,461; D436,579; RE35,364; RE36,703; RE37,986 and corresponding foreign patents. U.S. and foreign patents pending. Lutron and HomeWorks are registered trademarks of Lutron Electronics Co., Inc.
© 2003 Lutron Electronics Co., Inc.